

SHIMANO[®]

1988 REPAIR MANUAL

Shimano American Corporation, One Shimano Dr.
Irvine, CA 92718

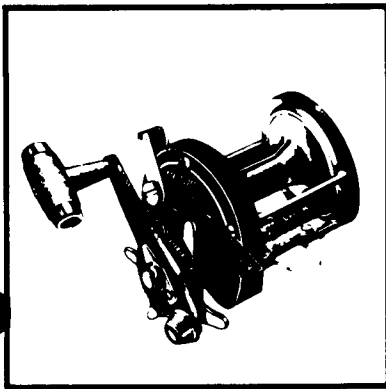
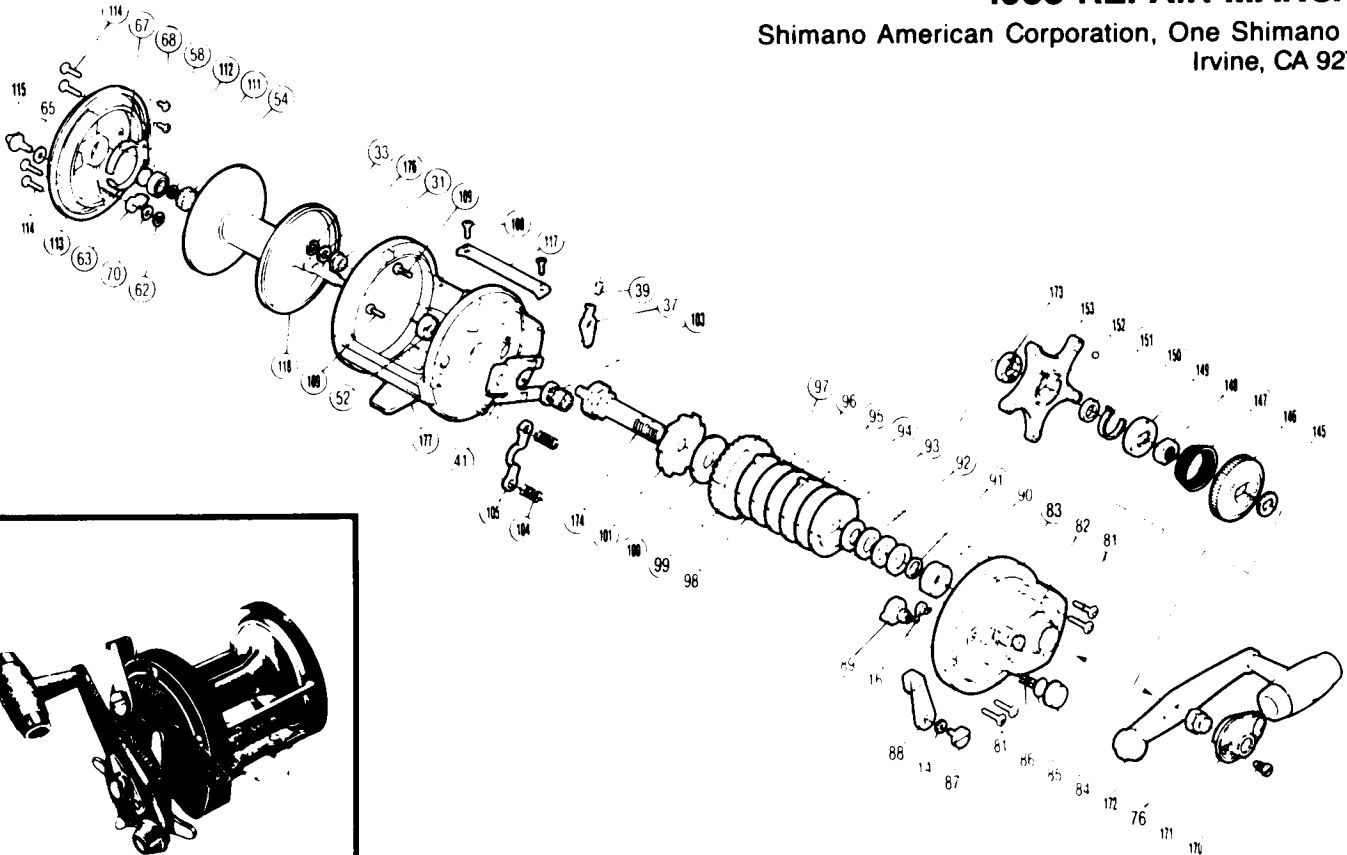

EXPLODED PARTS VIEW

TRITON *Speed Master* TSM IV FS
with *Fightin' Star*

PARTS LIST

PART # DESCRIPTION

TGT 0112	Ball Bearing
TGT 0113	Left Side Plate
TGT 0114	Left Side Plate Screw
TGT 0115	Click Button
TGT 0117	Line Guard
TGT 0118	Spool
TGT 0145	Friction Washer
TGT 0146	Pre-Set Dial
TGT 0147	Pre-Set Spring
TGT 0148	Pre-Set Nut
TGT 0149	Strike
TGT 0150	Strike Spring
TGT 0151	Strike Spacer
TGT 0152	Strike Ball
TGT 0153	Star Drag
TGT 0170	Handle Nut Plate Screw
TGT 0171	Handle Nut Plate
TGT 0172	Handle Assembly
TGT 0173	Drive Shaft Cam
TGT 0174	Drive Shaft
TGT 0176	Spacer
TGT 0177	Frame

PART # DESCRIPTION

TGT 0086	Spool Tension Spring
TGT 0087	Clutch Lever Screw
TGT 0088	Clutch Lever
TGT 0089	Clutch Cam
TGT 0090	Ball Bearing
TGT 0091	Bearing Thrust Washer
TGT 0092	Drag Spring Washer
TGT 0093	Key Washer "F"
TGT 0094	Drag Washer "D"
TGT 0095	Eared Washer "E"
TGT 0096	Drag Washer "I"
TGT 0097	Key Washer "C"
TGT 0098	Eared Washer "B"
TGT 0099	Drive Gear
TGT 0100	Drive Shaft Washer
TGT 0101	Anti-Reverse Ratchet
TGT 0103	Pinion Gear
TGT 0104	Yoke Spring
TGT 0105	Yoke
TGT 0108	Line Guard Screw
TGT 0109	Right Side Plate Screw (B)
TGT 0111	Click Gear Retainer

PART # DESCRIPTION

TGT 0014	Lock Washer
TGT 0016	Clutch Spring
TGT 0031	Drive Shaft Bushing
TGT 0033	Drive Shaft Retainer
TGT 0037	Anti-Reverse Pawl
TGT 0039	Anti-Reverse Pawl Spring
TGT 0041	Yoke Plate
TGT 0052	Ball Bearing
TGT 0054	Click Gear
TGT 0058	Spacer "B"
TGT 0062	Click Pawl Retainer
TGT 0063	Click Pawl
TGT 0065	Spacer A
TGT 0067	Click Spring
TGT 0068	Click Spring Screw
TGT 0070	Spacer B
TGT 0076	Handle Nut
TGT 0081	Right Side Plate Screw (A)
TGT 0082	Spool Shaft Bushing
TGT 0083	Right Side Plate
TGT 0084	Cast Control Cap
TGT 0085	Spacer