

Original Drag

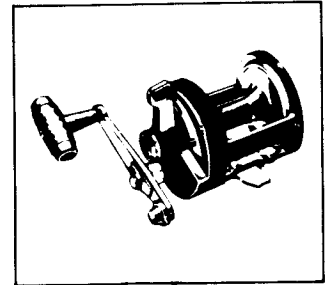
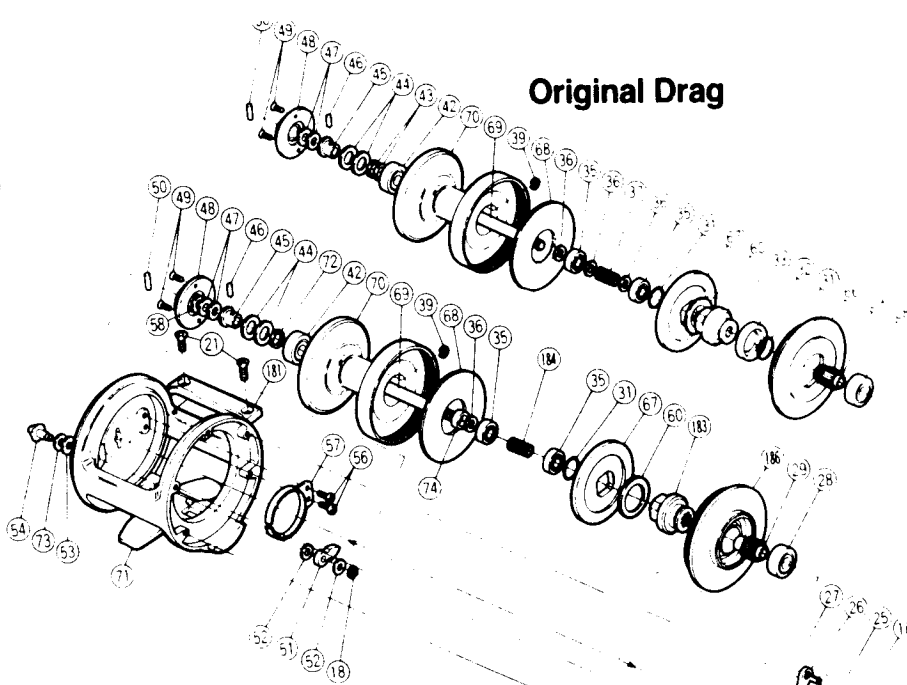

TO ORDER:

This reel belongs to the "Triton Lever Drag" series. Please order parts using the abbreviation "TLD" and the part number. The code numbers are for crossreference only.

EXPLODED PARTS VIEW TRITON® LEVER DRAG TLD 15

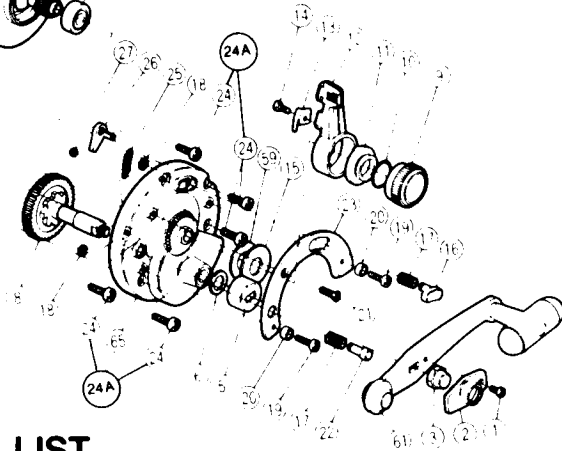

PARTS LIST

PART #	CODE #	DESCRIPTION	PART #	CODE #	DESCRIPTION
1.	7-0014 30111S	Handle Lock Screw	45.	7-1762 09000S	Pre-Load Body
2.	7-2124 06700S	Handle Lock	46.	7-1763 09000S	Cross Pin A
3.	7-2123 09000S	Handle Nut	47.	7-1738 09000S	Spacer A
5.	7-2171 09000S	Gear Shaft Shield	48.	6-1739 09000S	Click Gear
6.	7-2111 06101S	Gear Shaft Thrust Washer	49.	7-0012 00100S	Click Gear Screw
8.	6-2109 09000S	Main Gear	50.	7-1760 09000S	Cross Pin B
9.	6-2080 09000S	Pre-Program Dial	51.	7-1414 09300S	Click Pawl
10.	7-0160 32300S	Body "O" Seal	52.	7-1471 09300S	Click Pawl Washer
11.	7-2096 09000S	Lever Shaft Body	53.	7-1470 09300S	Click Button Washer A
12.	7-2076 09000S	Drag Control Lever	54.	7-1468 09000S	Click Button
13.	7-1445 09000S	Lever Click Spring	56.	7-0013 30140S	Click Spring Screw
14.	7-0014 30220S	Click Spring Screw	57.	7-1415 09001S	Click Spring
15.	7-2073 09000S	Lever Thrust Ring	59.		Spacer
16.	7-20B0 09000S	Strike Stop	60.	7-1755 09000S	Pre-Load Spring A
17.	7-20A2 09000S	Pressure Spring	61.	6-2129 09001S	Handle
18.	7-0040 30400S	"C" Lock	65.	6-2019 09020S	Side Plate
19.	7-0011 30611S	Quadrant Anchor Bolt	66.	7-1770 09020S	Cooling Shield
20.	7-2098 09000S	Bolt Shield	67.	6-1769 09020S	Drag Plate
21.	7-0012 30411S	Quadrant/Line Guard Screw	68.	7-1766 09020S	Titanium Drag Washer
22.	7-20A1 09000S	Free Spool Detent	69.	7-1702 09020S	Main Shaft
23.	7-2090 09000S	Lever Quadrant	70.	7-1701 09020S	Spool
24.	7-0013 40571S	Side Plate Bolt	71.	6-15A909020S	One-Piece Body
24A.		Side Plate Bolt (oversize)	72.	7-1754 090100	Pre-Load Washer A*
25.	7-1838 09000S	Dog Spring	73.	7-1620 09300S	Click Button Washer B
26.	7-1824 09000S	Dog	74.	7-1718 090000	Bushing**
27.	7-0050 01010S	Dog Spring Retainer	181.	7-15C70902 00	Line Guard*
28.	7-0402 27301S	Ball Bearing (with grease)	183.	6-1707 09000S	Pinion Guard (New)**
29.	7-1706 09000S	Pinion Gear	184.	7-1765 090010	Pressure Release Spring (New)**
31.	7-1768 09000S	Seal Lock	186.	6-1779 0902 10	Cooling Shield (New)** ***
32.	7-1771 09000S	Shield Seal			
33.	7-1707 09000S	Pinion Guard			
35.	7-1517 10000S	Ball Bearing			
36.	7-1764 09000S	Bearing Thrust Washer			
37.	7-1765 09000S	Pressure Release Spring			
39.	7-0042 18400S	"C" Lock			
42.	7-0402 27302S	Ball Bearing (with oil)			
43.	7-1754 09001S	Pre-Load Washer ****			
44.	7-1755 09002S	Pre-Load Spring B			

*Not present on early versions.
 **No interchangeability with older parts.
 ***Identified by rubber seal around center hole.
 ****Original drag used two pieces of part #43, newer reels use 1 piece of 72 instead.