

Shimano American Corporation, One Shimano Dr.
Irvine, CA 92718**EXPLODED PARTS VIEW**TRITON GRAPHITE CONSTRUCTION
BAITRUNNER Plus 6500 US

*Please look here for (89) mark here

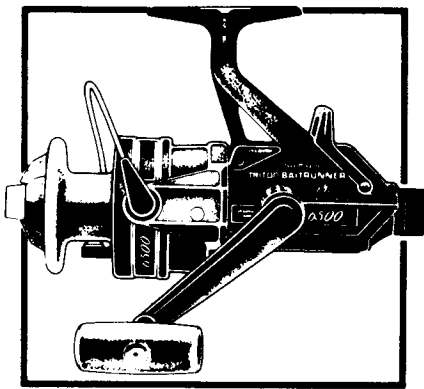
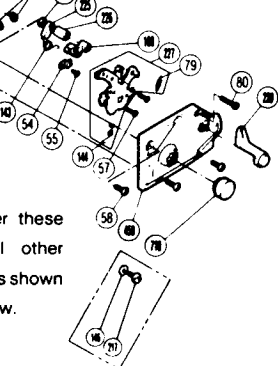
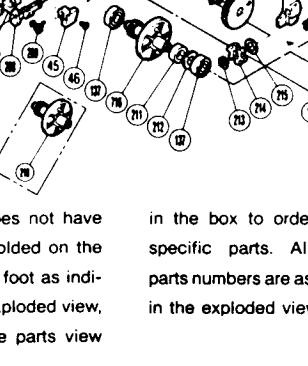
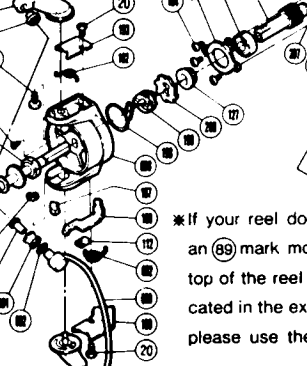
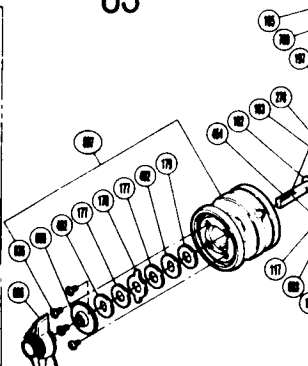
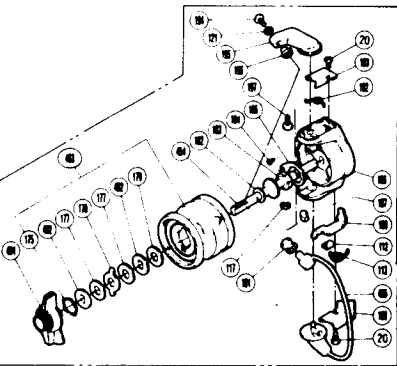
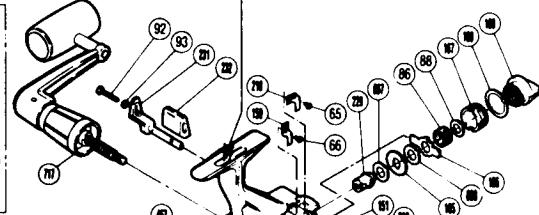
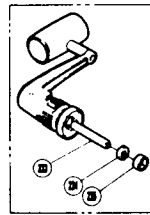

*If your reel does not have an (89) mark molded on the top of the reel foot as indicated in the exploded view, please use the parts view

in the box to order these specific parts. All other parts numbers are as shown in the exploded view.

PARTS LIST**PART # DESCRIPTION**

| | |
|---------|---------------------------|
| BR 0020 | Bail Trip Cover Screw |
| BR 0045 | Anti-Reverse Lever |
| BR 0046 | Anti-Reverse Lever Screw |
| BR 0054 | Lever Shaft Retainer |
| BR 0055 | Shaft Retainer Screw |
| BR 0057 | Clutch Plate Screw |
| BR 0058 | Side Cover Screw A |
| BR 0065 | Dial Click Screw |
| BR 0066 | Pawl Guide Screw |
| BR 0074 | Clutch Cam Spacer B |
| BR 0079 | Baitrunner Click Spring |
| BR 0080 | Side Cover Screw B |
| BR 0086 | Free Spool Tension Spring |
| BR 0088 | Tension Spring Washer "B" |
| BR 0092 | Baitrunner Lever Screw |
| BR 0093 | Lock Washer |
| BR 0112 | Trip Lever Guide |
| BR 0113 | Lever Spring |
| BR 0117 | "E" Lock |
| BR 0121 | Lock Washer |
| BR 0127 | Pinion Spacer |
| BR 0129 | Ball Bearing |
| BR 0137 | Ball Bearing |
| BR 0143 | Clutch Spring |
| BR 0144 | Clutch Pawl Spring |
| BR 0146 | Handle Lock Washer |
| BR 0150 | Baitrunner Pawl Guide |
| BR 0151 | Baitrunner Pawl Spring |
| BR 0153 | Dial Retainer |
| BR 0160 | Clutch Arm |
| BR 0165 | Click Gear |
| BR 0166 | Eared Washer "BFS" |
| BR 0167 | Free Spool Tension Screw |
| BR 0168 | Dial Spacer |
| BR 0169 | Baitrunner Tension Dial |
| BR 0175 | Drag Washers Retainer |
| BR 0177 | Drag Washer 1 |

PART # DESCRIPTION

| | |
|---------|----------------------------|
| BR 0178 | Eared Washer |
| BR 0179 | Drag Washer 2 |
| BR 0182 | Spool Washer |
| BR 0183 | Rotor Nut |
| BR 0184 | Multi Purpose Screw |
| BR 0185 | Rotor Nut Lock Plate |
| BR 0186 | Rotor |
| BR 0187 | Bail Trip Slide Cam |
| BR 0188 | Bail Trip Lever |
| BR 0190 | Bail Trip Cover |
| BR 0191 | Line Roller |
| BR 0192 | Bail Spring |
| BR 0193 | Bail Spring Cover |
| BR 0194 | Line Roller Screw |
| BR 0195 | Bail Arm |
| BR 0196 | Line Roller Washer |
| BR 0197 | Bail Arm Screw |
| BR 0198 | Anti-Reverse Pawl Spring |
| BR 0199 | Anti-Reverse Spring Holder |
| BR 0200 | Anti-Reverse Ratchet |
| BR 0201 | Bearing Retainer |
| BR 0202 | Pinion Gear |
| BR 0204 | Anti-Reverse Pawl |
| BR 0207 | Pinion Gear Bushing |
| BR 0208 | Anti-Reverse Cam |
| BR 0209 | Anti-Reverse Cam Spring |
| BR 0211 | Drive Gear Spacer |
| BR 0212 | Drive Gear Washer |
| BR 0213 | "C" Lock |
| BR 0214 | Baitrunner Ratchet |
| BR 0215 | Ratchet Spacer |
| BR 0217 | Handle Lock Screw |
| BR 0218 | Dial Click |
| BR 0219 | Baitrunner Pawl |
| BR 0220 | Oscillating Gear Bushing |
| BR 0221 | Oscillating Gear |
| BR 0222 | Oscillating Slider |

PART # DESCRIPTION

| | |
|---------|-------------------------------|
| BR 0223 | "C" Lock |
| BR 0225 | Clutch Cam |
| BR 0226 | Clutch Cam Spacer A |
| BR 0227 | Clutch Plate Assembly |
| BR 0228 | Baitrunner Lever Arm (L) |
| BR 0229 | Free Spool Tension Shaft |
| BR 0231 | Baitrunner Lever Arm (R) |
| BR 0232 | Baitrunner Lever Bridge |
| BR 0233 | Handle Assembly |
| BR 0234 | Handle Lock Spacer |
| BR 0235 | Handle Lock Ring |
| BR 0278 | Nut Lock Screw |
| BR 0386 | Anti-Reverse Pawl Screw |
| BR 0451 | Fightin' Drag Knob |
| BR 0452 | Key Washer |
| BR 0453 | Spool Assembly |
| BR 0454 | Main Shaft |
| BR 0455 | Bail Assembly |
| BR 0457 | Body |
| BR 0458 | Side Cover |
| BR 0636 | Seal Plate Screw |
| BR 0662 | Lever Spring |
| BR 0667 | Free Spool Tension Washer (A) |
| BR 0668 | Free Spool Tension Washer (B) |
| BR 0688 | Seal Plate |
| BR 0692 | Line Roller Spacer |
| BR 0693 | Line Roller Bushing |
| BR 0695 | Line Roller Screw |
| BR 0696 | Fightin' Drag Knob |
| BR 0697 | Spool Assembly |
| BR 0698 | Rotor |
| BR 0699 | Bail Assembly |
| BR 0700 | Line Roller Washer |
| BR 0710 | Handle Screw Cap |
| BR 0716 | Drive Gear |
| BR 0717 | Handle Assembly |